

KEEP FOR FUTURE REFERENCE

INSTRUCTIONS

MANUAL



908 W. Main • P.O. Box 368

Laurel, MT USA 59044

800-548-7341 (phone)

406-628-8231 (phone)

406-628-8354 (fax)

www.WPG.com

 **INTENDED FOR USE BY SKILLED PROFESSIONALS • READ AND UNDERSTAND BEFORE ASSEMBLING/INSTALLING**



PAD FRAME EXTENSION KIT, ROCKER ARMS FOR MRTALP-DC3 LIFTERS

Stock numbers: 97463, 97464

TABLE OF CONTENTS

SPECIFICATIONS2

FEATURES.....3

ASSEMBLY6

 TO CHANGE THE PAD FRAME CONFIGURATION6

 TO INSTALL/REMOVE EXTENSION KIT9

 TO INSTALL/REMOVE ROCKER ARMS12

 TO INSTALL/REMOVE T-ARM ASSEMBLIES13

 TO CONNECT/DISCONNECT VACUUM HOSES14

REPLACEMENT PARTS.....15



LIMITED WARRANTY16

 TO OBTAIN REPAIRS OR WARRANTY SERVICE.....16

SPECIFICATIONS

Stock Numbers/ Product Descriptions	97464 (Extension Kit): This option enables an MRTALP-DC3 lifter to handle long loads in the flat orientation. ¹
	97463 (Rocker Arms): This option enables an MRTALP-DC3 lifter to handle loads with increased weight and length in the flat orientation. <i>Note: This option requires use of Extension Kit (#97464) and an addition set of T-Arm Assemblies (#97465 or #97465HV)</i>

1..... An MRTALP-DC lifter equipped with an Extension Kit (with or without Rocker Arms) can used to handle loads positioned on inclines up to a 4/12 pitch.

Adjusted Maximum Pad Spread¹	Extension Kit, Rocker Arms and 2 sets of T-Arm Assemblies	Extension Kit and 1 set of T-Arm Assemblies
with VPSF625 pads	37" x 392½" [94 cm x 997 cm]	37" x 324¾" [94 cm x 825 cm]
with VPSF10T pads	45" x 378" [114 cm x 960 cm]	45" x 310¼" [114 cm x 788 cm]
 Adjusted Maximum Load Capacity	1100 lbs [500 kg]	600 lbs [270 kg]
 Weight Increase²	225 lbs [102 kg]	100 lbs [46 kg]

1..... See "TO CHANGE THE PAD FRAME CONFIGURATION" for dimensions of various configurations.

2..... This weight should be added to the Lifter Weight when determining hoisting equipment capacity.

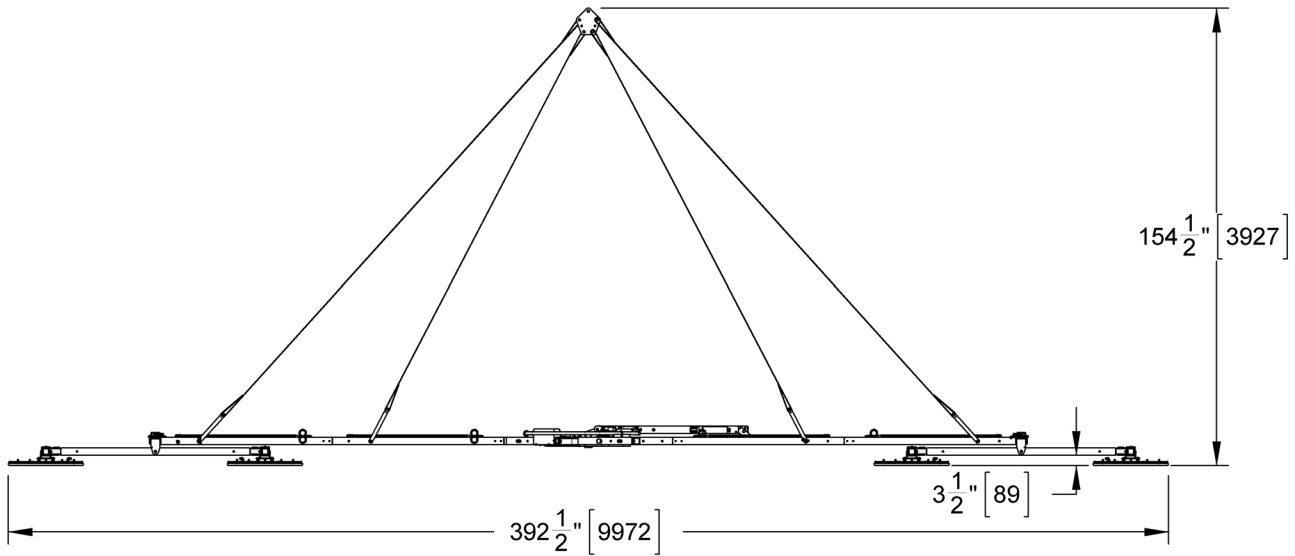

Note: An Extension Kit (including slings, shackles & lift spool assembly), Rocker Arms and 2 sets of Pad Frame T-Arm Assemblies equipped with VPSF625 vacuum pads are shown installed on a model MRTALP-DC3 vacuum lifter.

*Note: Before installing the Extension Kit and Rocker Arms read, understand and follow the lifter's OPERATING INSTRUCTIONS and the T-Arm Assemblies INSTRUCTIONS MANUAL (#35178AFT) **except when directed differently in these option instructions.** Intended use, operation, storage, inspections, tests and maintenance in the lifter's instructions should be understood to include options, when relevant. All warnings in the "SAFETY" section, as well as alerts in other sections, are applicable when using the Extension Kit and Rocker Arms.*

FEATURES

Features shown here are underlined on their first appearance in each section following.

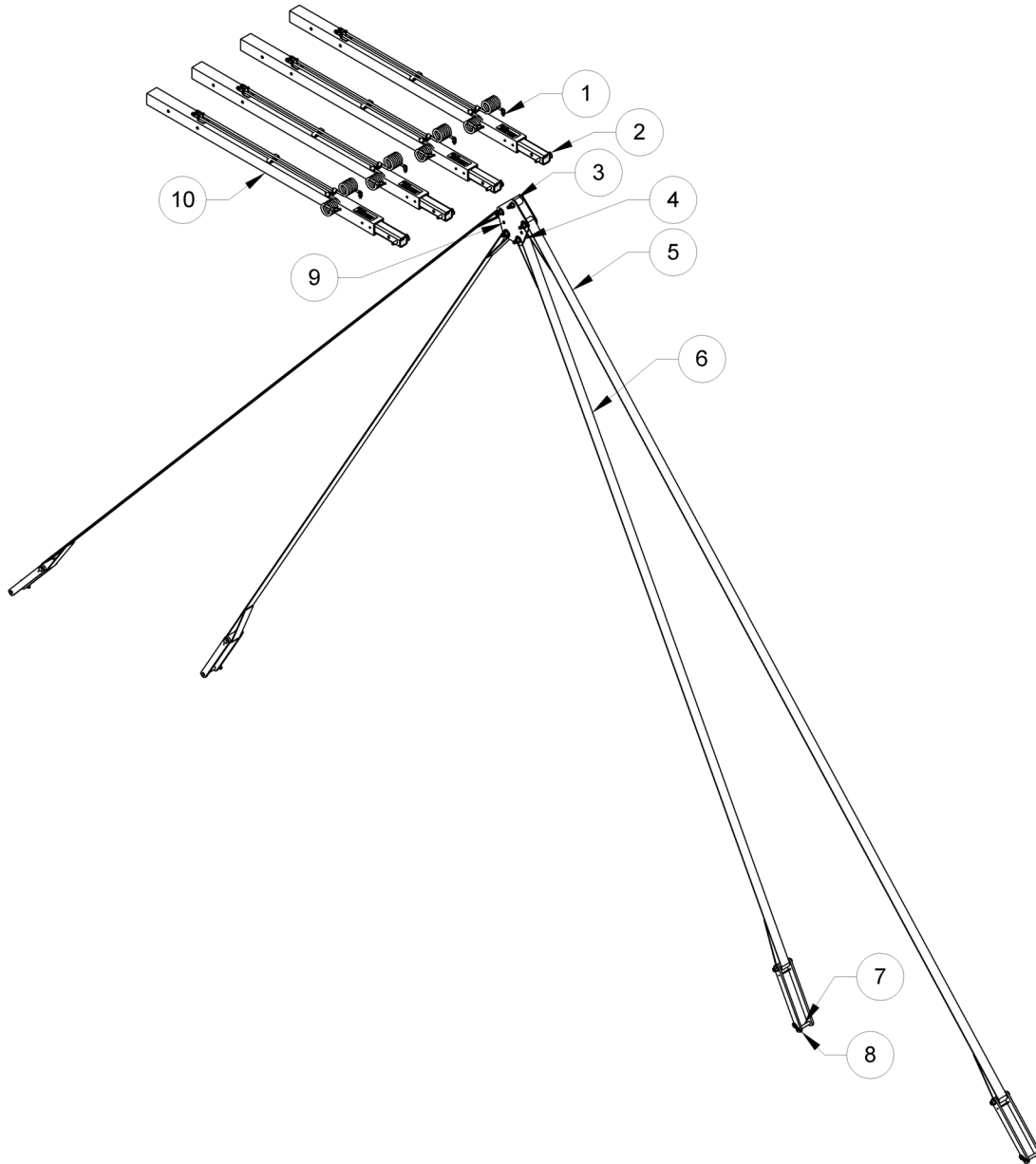

- | | | | | | |
|----|----------------------|----|------------------------|---|------------------------|
| 1 | MALE QUICK CONNECTOR | 2 | COTTERLESS HITCH PIN | 3 | LIFT POINT (TOP SPOOL) |
| 4 | LIFT SPOOL ASSEMBLY | 5 | LONG (OUTSIDE) SLING | 6 | SHORT (INSIDE) SLING |
| 7 | CLEVIS PIN | 8 | HAIRPIN | 9 | LONG SLING PIN HOLE |
| 10 | EXTENSION ARM | 11 | FEMALE QUICK CONNECTOR | | |

Note: Pad Frame Extension Kit (#97464) is shown.

For information about specific parts, see ["REPLACEMENT PARTS"](#).

FEATURES

Features shown here are underlined> on their first appearance in each section following.

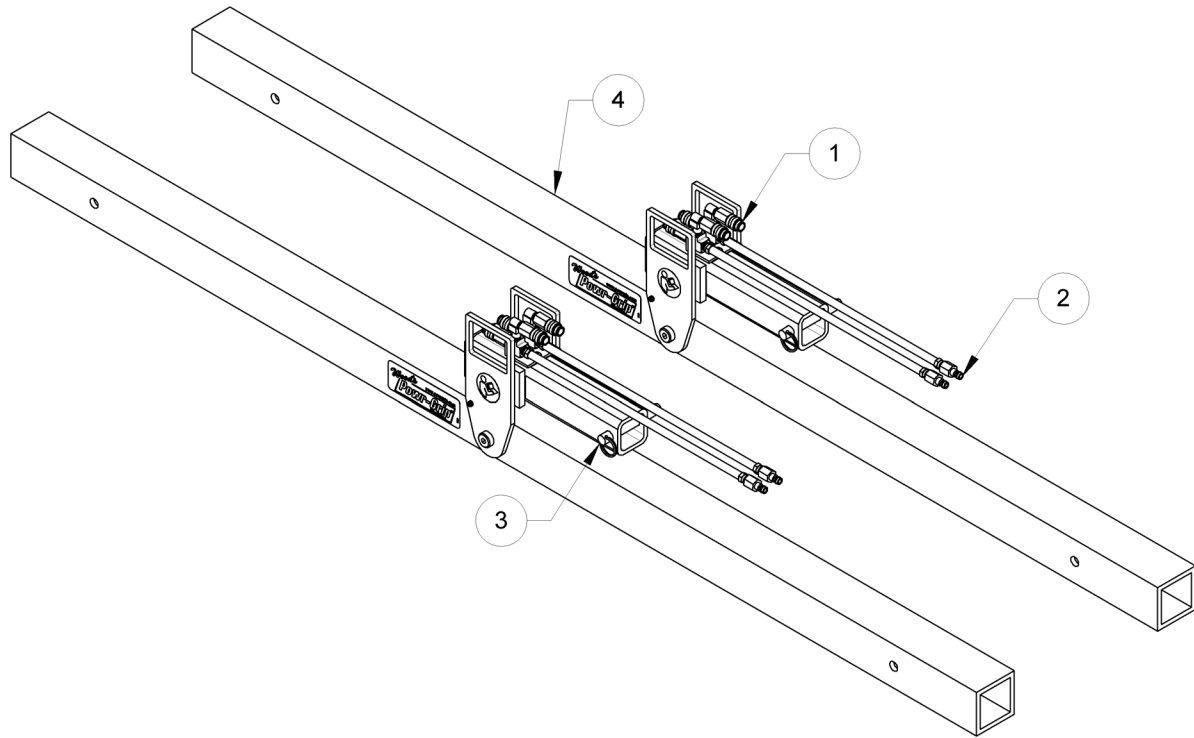

- | | | | |
|---|------------------------|---|----------------------|
| 1 | FEMALE QUICK CONNECTOR | 2 | MALE QUICK CONNECTOR |
| 3 | COTTERLESS HITCH PIN | 4 | ROCKER ARM TUBE |

Note: Pad Frame Rocker Arms (#97463) are shown.

For information about specific parts, see ["REPLACEMENT PARTS"](#).

FEATURES

Features shown here are underlined> on their first appearance in each section following.

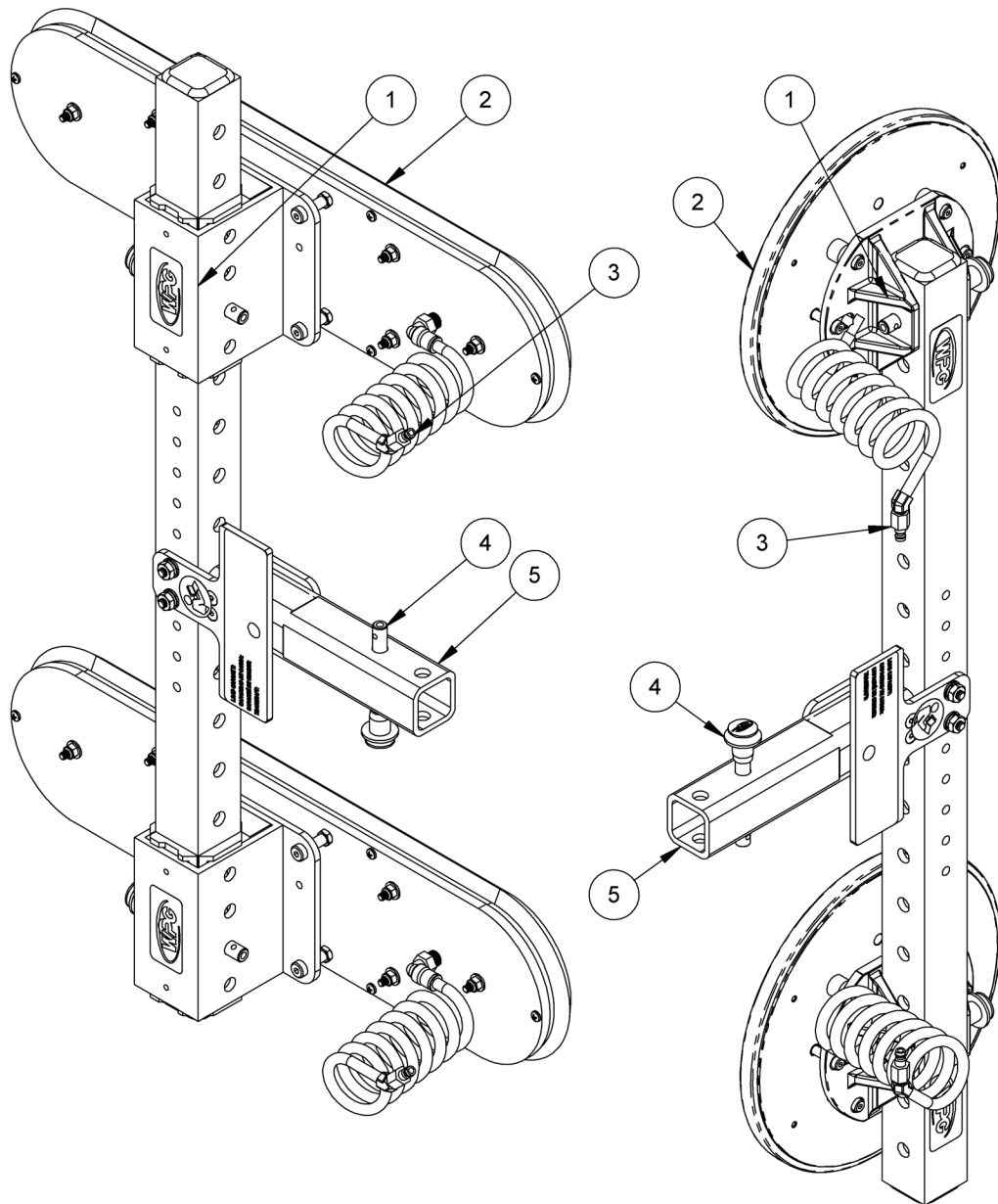

- | | | | | | |
|---|-----------------------------|---|---------------|---|-----------------|
| 1 | SLIDING / MOVABLE PAD MOUNT | 2 | VACUUM PAD | 3 | QUICK CONNECTOR |
| 4 | COTTERLESS HITCH PIN | 5 | EXTENSION ARM | | |

Note: A Pad Frame T-Arm Assembly with VPSF625 pads is shown at left (#97465) and with VPSF10T pads at right (#97465HV).

For information about the assemblies, see [“REPLACEMENT PARTS”](#).

ASSEMBLY

TO CHANGE THE PAD FRAME CONFIGURATION

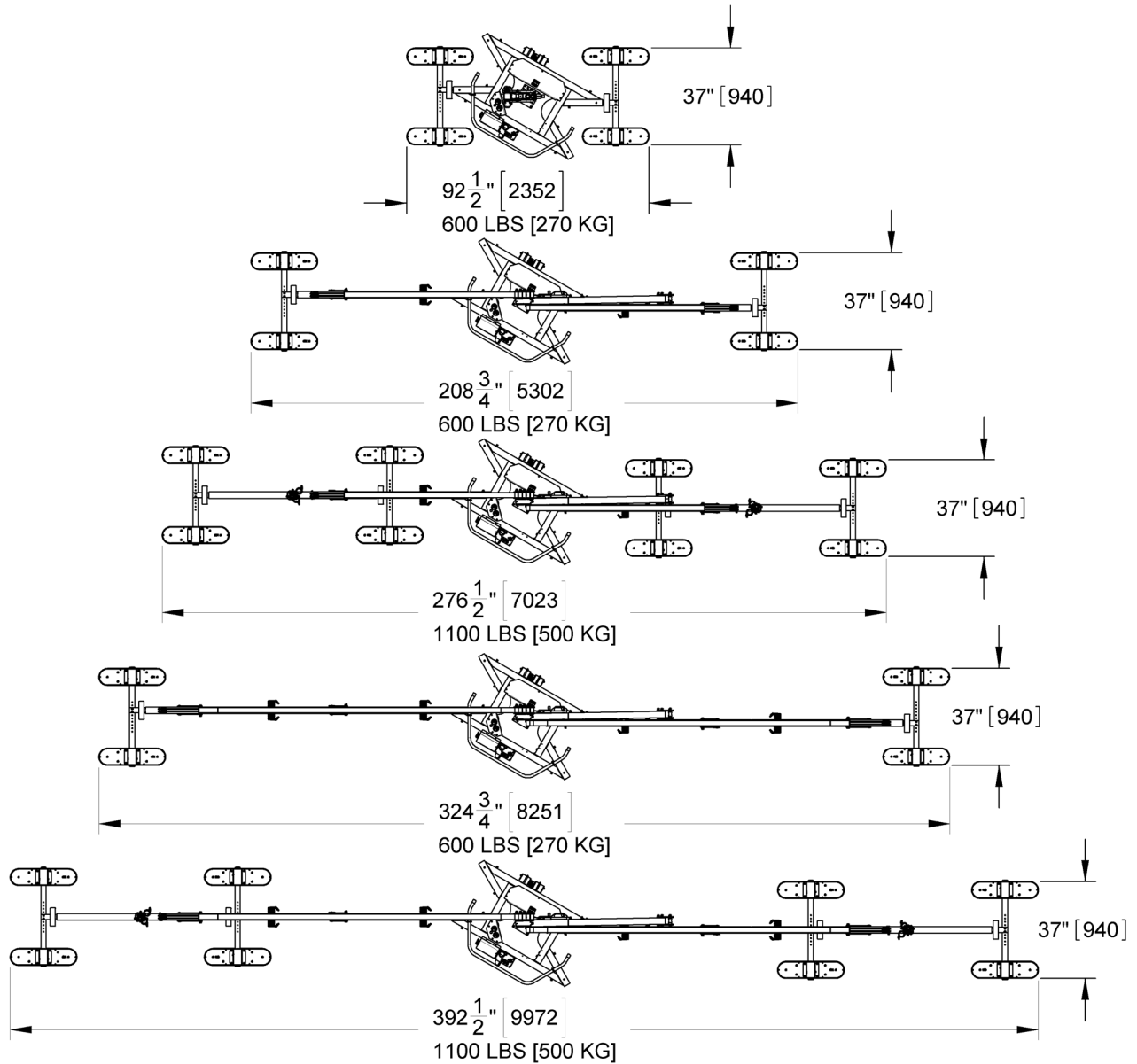

Pad Spread and Maximum Load Capacity

Configurations are shown with the following optional components and VPFS625 vacuum pads installed (from top to bottom):

Configuration 1	1 set of T-Arm Assemblies
Configuration 2	Extension Kit (2 arms in use) and 1 set of T-Arm Assemblies
Configuration 3	Extension Kit (2 arms in use), Rocker Arms, and 2 sets of T-Arm Assemblies
Configuration 4	Extension Kit (4 arms in use) and 1 set of T-Arm Assemblies
Configuration 5	Extension Kit (4 arms in use), Rocker Arms, and 2 sets of T-Arm Assemblies

ASSEMBLY

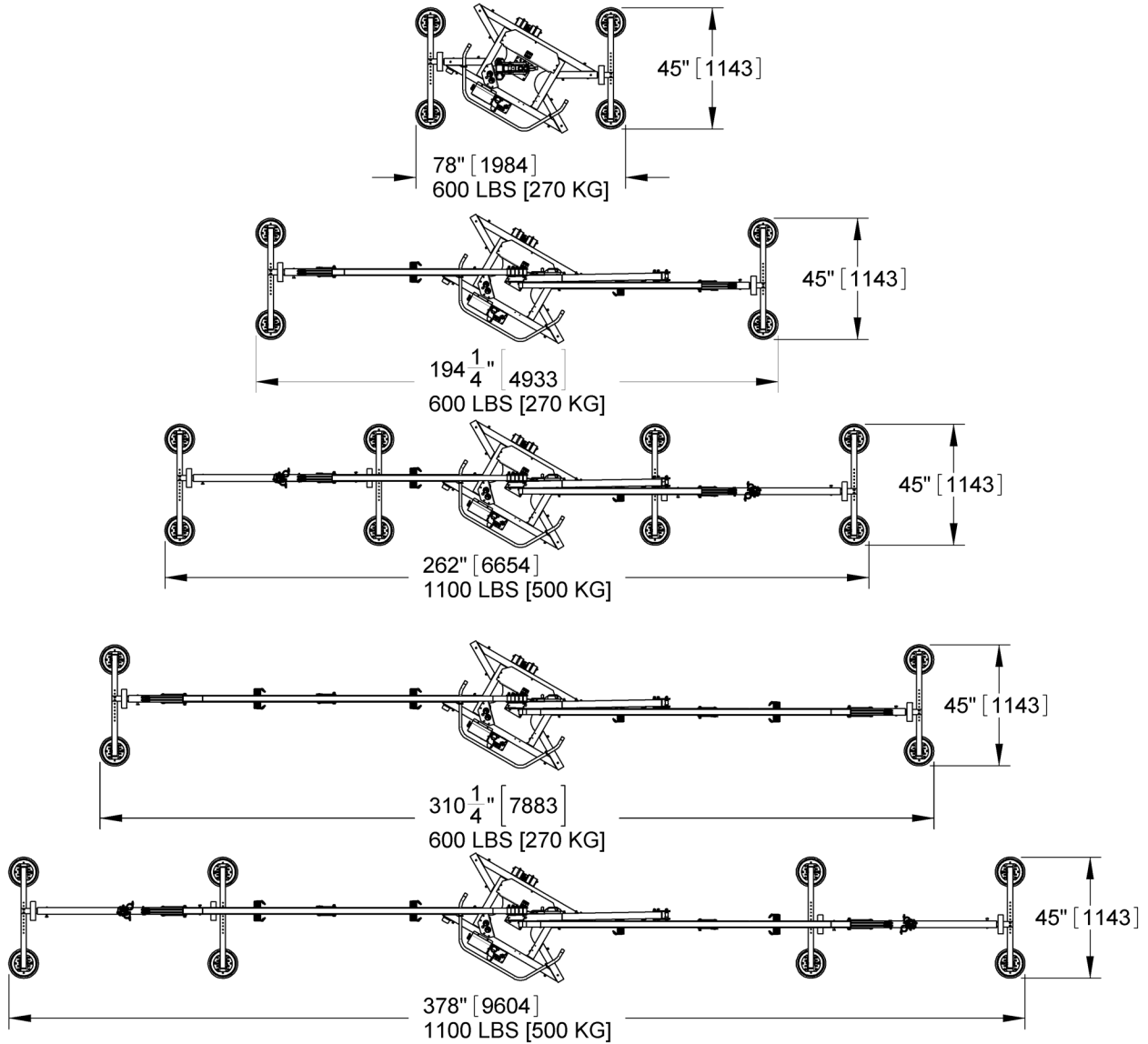

Pad Spread and Maximum Load Capacity

Configurations are shown with the following optional components and VPFS10T vacuum pads installed (from top to bottom):

Configuration 1	1 set of T-Arm Assemblies
Configuration 2	Extension Kit (2 arms in use) and 1 set of T-Arm Assemblies
Configuration 3	Extension Kit (2 arms in use), Rocker Arms, and 2 sets of T-Arm Assemblies
Configuration 4	Extension Kit (4 arms in use) and 1 set of T-Arm Assemblies
Configuration 5	Extension Kit (4 arms in use), Rocker Arms, and 2 sets of T-Arm Assemblies

ASSEMBLY

These optional components offer a variety of configurations that enable the lifter to match different dimensions and weights of rigid roof panels and similar loads. The illustrations on the two preceding pages show all approved configurations.

Choose an approved configuration to maximize support across the load surface and minimize load overhang (see “LOAD CHARACTERISTICS” in the lifter’s *OPERATING INSTRUCTIONS*).

The pad frame configuration selected must be appropriate, both for the weight and for the dimensions of the load in question (see “SPECIFICATIONS” and configuration illustrations). Install or remove extension arms, rocker arms and T-arm assemblies as necessary to support the load adequately (see following sections).

Note: Separate *INSTRUCTIONS FOR USE (#35178AFT)* are provided with the T-arm assemblies; read and understand these instructions before employing them.

Always arrange the vacuum pads in a symmetrical configuration about the MRTALP-DC3's main pad frame, to keep the lifter balanced.

To prevent lifter damage when using the extension kit (and rocker arms), always use the kit’s lift spool assembly and slings regardless of the configuration selected.



Never use a sling that has knots, twists or wear that could compromise its strength.



Never use a sling if the capacity tag is missing or unreadable.

After changing the configuration, suspend the lifter from a crane as directed in the “ASSEMBLY” section of the lifter’s *OPERATING INSTRUCTIONS*.



Securely position vacuum hoses to avoid damage during lifter operation.

TO INSTALL/REMOVE EXTENSION KIT

- 1) Remove any pad frame extensions and/or T-arm assemblies from the vacuum lifter (see “TO INSTALL/REMOVE T-ARM ASSEMBLIES”).
- 2) Set the lifter down, as directed in the lifter’s *OPERATING INSTRUCTIONS*.
- 3) Install one extension arm on the lifter’s pad frame in a similar way to that described in “TO INSTALL/REMOVE T-ARM ASSEMBLIES”. Repeat with another extension arm.

Note: Consult the configuration illustrations for correct orientation of the extension arms (see “TO CHANGE THE PAD FRAME CONFIGURATION”).

Note: Make sure to connect corresponding vacuum hoses correctly (see “TO CONNECT/DISCONNECT VACUUM HOSES”).

- 4) Attach the hoisting hook to the lift point, which is the top spool of the lift spool assembly (circled in fig. 4A).



Make sure hook has restraining latch (fig. 4B).

Note: Some hooks may not be compatible with the lift spool assembly. If not, use rigging as needed to connect the hook with the top spool (fig. 4C).¹



Use only rigging rated to carry Maximum Load Capacity plus Lifter Weight.



ASSEMBLY

- 5) Remove the hairpin from a short sling's mount (fig. 5A), to remove the clevis pin (fig. 5B).

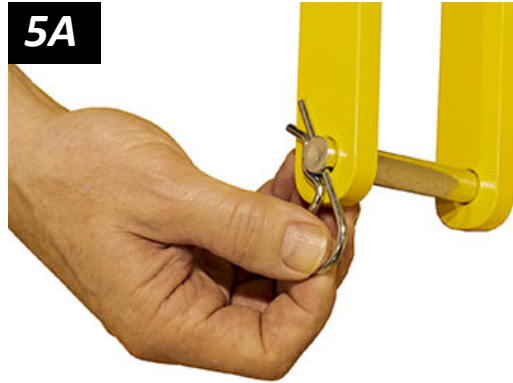

Then attach the short sling to one extension arm by installing and securing it with both pins (figs. 5C-E).



Repeat with the other extension arm.

- 6) When required for the selected configuration, install a second set of extension arms onto the first set, similarly to step 3.
- 7) When required for the selected configuration, attach the long slings to the second set of extension arms, similarly to step 5.

- When using Configuration 2 or 3 (see [“TO CHANGE THE PAD FRAME CONFIGURATION”](#)), the long slings are not needed (fig. 7A).

7A



Caution: To prevent the unused long slings from damage or interfering with a lift, use their clevis pins to secure them to the lift spool assembly's long sling pin holes (arrows in fig. 7A inset).

1..... Rigging for use directly with the hoisting hook is **not** supplied with the extension kit.

ASSEMBLY

- When using Configuration 4 or 5 (see [“TO CHANGE THE PAD FRAME CONFIGURATION”](#)), the long slings are needed (fig. 7B).

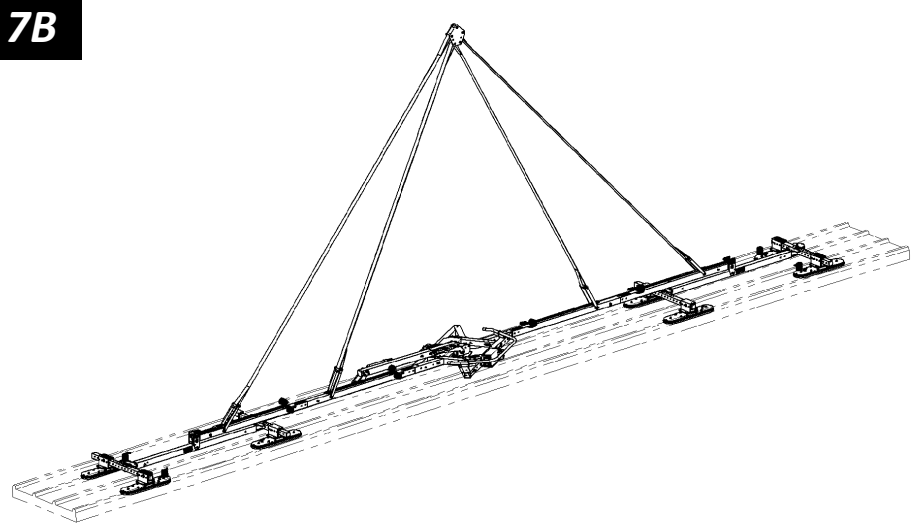

- 8) Install rocker arms and T-arm assemblies per the selected configuration (see [“TO INSTALL/REMOVE ROCKER ARMS”](#) and [“TO INSTALL/REMOVE T-ARM ASSEMBLIES”](#)).

To remove the extension kit, reverse steps 1-8. Store the extension kit in a clean, dry location.

ASSEMBLY

TO INSTALL/REMOVE ROCKER ARMS

Note: Extension arms must be installed before installing rocker arms. If T-arm assemblies were previously installed in the extension arms, remove the assemblies (see “TO INSTALL/REMOVE T-ARM ASSEMBLIES”).

- 1) Insert the male end of a rocker arm into the female end of an extension arm (fig. 1A) until the holes for the cotterless hitch pin align. Secure with the hitch pin (fig. 2A). Repeat for the other rocker arm.

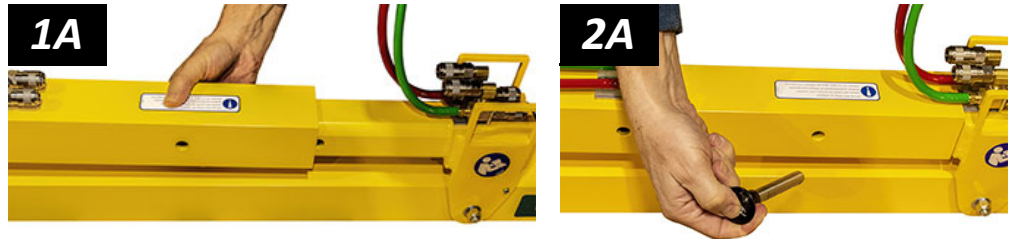

- 2) Use the quick connectors (see) to connect the 2 vacuum hoses from the extension arm to the rocker arm:

- 2.1) Connect hoses between the extension arm and the rocker arm (fig. 1B). Repeat with the other rocker arm.

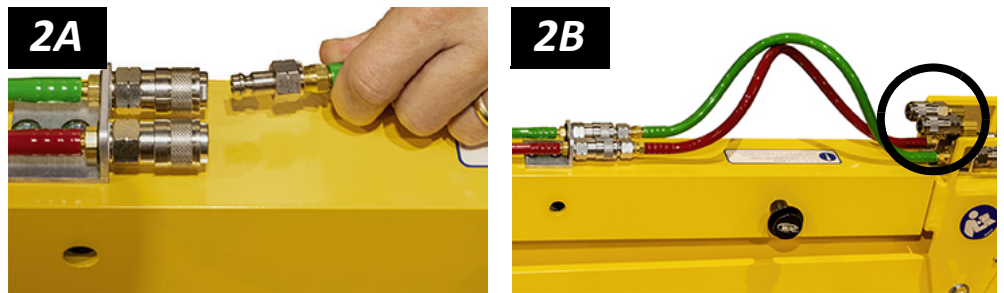

- 2.2) Install 2 T-arm assemblies on each rocker arms (see “TO INSTALL/REMOVE T-ARM ASSEMBLIES”).

To remove the rocker arms, reverse steps 1-2. Store the rocker arms in a clean, dry location.

ASSEMBLY

TO INSTALL/REMOVE T-ARM ASSEMBLIES

Note: Use only 2 vacuum pads on each T-arm assembly.

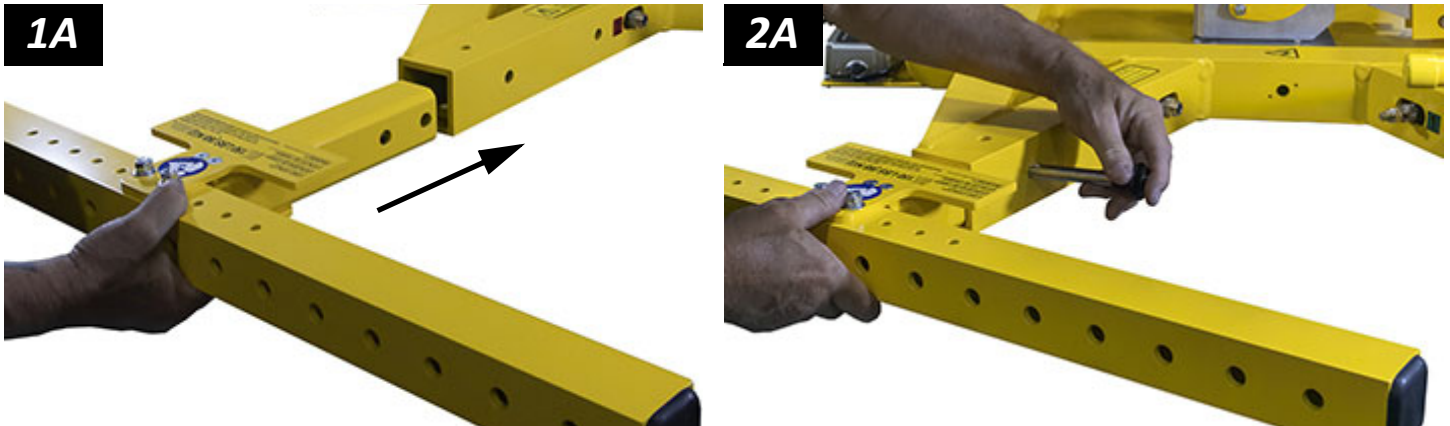

- 1) Depending on the selected configuration, insert a T-arm assembly extension arm into either the extension arm's tube or rocker arm tube (fig. 1A).
- 2) Use a cotterless hitch pin, to secure the T-arm (fig. 2A).
- 3) Use the quick connectors to connect all vacuum pad hoses to their corresponding female quick connectors on either the extension arms or rocker arms (see).
- 4) Repeat steps 1-3, to install the other T-arm assembly or assemblies.

To remove the T-arm assemblies, reverse steps 1-4. Store the assemblies in a clean, dry location.

Caution: Do not set the assemblies on surfaces that could soil or damage the vacuum pads. Protect the sealing edges of the pads by making sure each pad rests on spacers.¹

1..... The original shipping container has integrated spacers. Use similarly shaped spacers when setting the assemblies on other surfaces.

ASSEMBLY

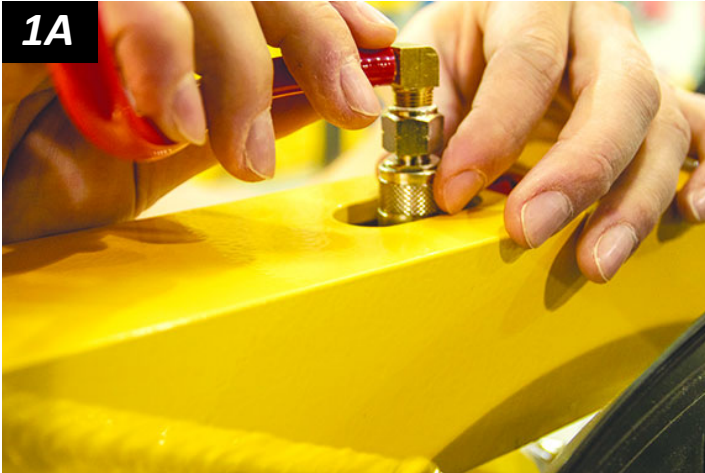

TO CONNECT/DISCONNECT VACUUM HOSES

- To *connect* a vacuum hose, push the male and female ends of the quick connector together until they lock (fig. 1A).
- To *disconnect* a hose, move the release ring on the female end until the quick connector separates (fig. 2A).

Note: Make sure each hose is connected to the correct vacuum circuit, as indicated by green and red colors (fig. 1B).



Make sure quick connectors seal completely and all vacuum hoses function correctly (see “Vacuum Test” in the lifter’s OPERATING INSTRUCTIONS).



Securely position vacuum hoses to avoid damage during lifter operation.

1B



REPLACEMENT PARTS

Stock No.	Description	Qty.
97465	Optional Pad Frame T-Arm Assemblies – VPFS625 (set of 2)	(1/2)
97465HV	Optional Pad Frame T-Arm Assemblies – VPFS10T (set of 2)	(1/2)
65440	Vacuum Hose – 1/4" ID x 3/8" OD – Red	*
65437	Vacuum Hose – 1/4" ID x 3/8" OD – Green	*
65324CH	Lift Sling – 12' Length	2
65324CD	Lift Sling – 15' Length	2
65313AM	Velcro Strap – 1" x 24"	4
16057	Quick Connector – 1/8 FNPS – Male End	8
16056	Quick Connector – 1/8 FNPS – Female End (for extension kit)	8
16056	Quick Connector – 1/8 FNPS – Female End (for rocker arms)	4
13435	Clevis Pin – 1/2" x 3-1/2"	4
13219	Hairpin – 0.120" Diameter (for clevis pin)	4

* – Length as required; sold by the foot (approx 30.5 cm).

**SERVICE ONLY WITH IDENTICAL REPLACEMENT PARTS,
AVAILABLE AT WPG.COM OR THROUGH AN AUTHORIZED WPG DEALER**

LIMITED WARRANTY

Wood's Powr-Grip® (WPG) products are carefully constructed, thoroughly inspected at various stages of production, and individually tested. They are warranted to be free from defects in workmanship and materials for a period of one year from the date of purchase.

If a problem develops during the warranty period, follow the instructions below to obtain warranty service. If inspection shows that the problem is due to defective workmanship or materials, WPG will repair the product without charge.

Warranty does not apply when ...

- modifications have been made to the product after leaving the factory
- rubber portions have been cut or scratched during use;
- repairs are required due to abnormal wear and tear, and/or;
- the product has been damaged, misused or neglected.

If a problem is not covered under warranty, WPG will notify the customer of costs prior to repair. If the customer agrees to pay all repair costs and to receive the repaired product on a C.O.D. basis, then WPG will proceed with repairs.

TO OBTAIN REPAIRS OR WARRANTY SERVICE

For purchases in *North America*:

Contact the WPG Technical Service Department. When factory service is required, ship the complete product – prepaid – along with your name, address and phone number to the street address listed at the bottom of this page. WPG may be reached by phone or fax numbers listed below.

For purchases in all *other localities*:

Contact your dealer or the WPG Technical Service Department for assistance. WPG may be reached by phone or fax numbers listed below.

Wood's Powr-Grip Co., Inc.

908 West Main St.

Laurel, MT 59044 USA

406-628-8231 (phone)

800-548-7341 (phone)

406-628-8354 (fax)