

MOUNTING PLATFORM CUP INSTRUCTIONS



OPERATION

To Attach

- 1) Clean the contact surface and, if needed, the face of the rubber pad (see Cleaning).
Caution: Some rubber compounds may stain light surfaces or deform soft coatings. When in doubt, test a sample of such materials for permanent effects.
- 2) Position the vacuum cup so the red line will be visible if it should appear while the cup is attached.
- 3) Press the rubber pad against the contact surface as needed to form a continuous seal.
Caution: Make sure the surface material is supported as needed to prevent breakage.
- 4) Pump the plunger until the cup attaches completely. The red line serves as a vacuum indicator: When the red line is hidden, the cup is ready for use.
- 5) Check the plunger frequently to make sure the cup remains securely attached. If the red line appears, pump the plunger until the red line is hidden again (see WARNINGS).

To Release

- 1) Secure the load.
- 2) Press the release lever until the cup disengages completely.
Caution: Remove the cup when not in use.¹



SCAN OR CLICK TO WATCH INSTRUCTIONAL VIDEO

SPECIFICATIONS

Product Description

This tool uses vacuum to mount loads temporarily, as follows:

Mounting Points

- 1/4-20 and 3/8-16 tapped holes

Environmental Conditions

- Temperatures: 10° to 120° F (-12° to 49° C)¹
- Elevation: up to 5,000' (1,524 m).

Note: Maximum Load Capacity includes a 3:1 design factor and requires:

- Attachment on clean, dry, relatively smooth, flat, nonporous surfaces²
- Minimum vacuum level of 17-1/2" Hg (-59 kPa)
- Friction coefficient of 1

Mounting Platform Kit (90130)

- 1) 10400 Screw, 1/4-20 x 3-1/2"
- 2) 52140 Mounting Plate
- 3) 52142 Standoff

If the kit was purchased separately, remove the handle screws from your WPG N-Series vacuum cup. Attach the mounting kit as shown, using the long screws provided. Then tighten the screws securely. Consult your original cup instructions for the relevant Maximum Load Capacity.

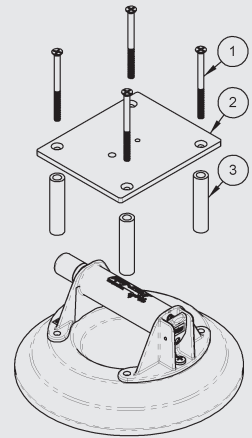

Model	Rubber Pad	Nominal Diameter	Max. Load Capacity ³	Contact Surface
N6000P	G0750	10" (25 cm)	175 lbs (79 kg)	curved or irregular ^{4,5}

- ¹ If the cup remains attached to a hot surface (eg, in direct sunlight) for an extended time, the rubber pad could bond with the surface, resulting in damage to the surface or to the pad when it is removed.
- ² Moisture or contaminants can reduce the slip resistance of the rubber pad.
- ³ The Maximum Load Capacity is based on testing under controlled conditions with new vacuum cups attached to flat, horizontal surfaces. Many factors can reduce the capacity, such as:
 - mounting a load when the cup is attached to a vertical or inclined surface
 - dynamic loading (eg, mounting loads on moving vehicles)
 - mounting a load that applies leverage to the cup (see www.wpg.com/mccc to calculate capacities for specific loads)
- Caution:** The user must be able to monitor the red line and repump the plunger whenever the cup is in use. If not, a secondary restraint may be needed to protect mounted equipment. Contact an authorized dealer or WPG for more information.
- ⁴ Extreme surface variation may prevent the cup from attaching or remaining attached.
- ⁵ **Caution:** Do not attach this cup to thin, fragile materials.

MAINTENANCE

Service

If the vacuum cup does not function normally, first clean the rubber pad according to the directions to follow. If the condition persists, see TROUBLESHOOTING.

Note: Replace the pad at least once every 2 years or whenever damage is discovered (see Inspection).

Cleaning

- 1) Remove the air filter from the rubber pad.
- 2) Use a clean sponge or lint-free cloth to apply soapy water or another mild cleanser to the pad face (see WARNINGS).
Caution: To prevent liquid from contaminating the pump, hold the cup face-down or cover the suction hole in the filter recess.
- 3) Wipe all residue from the pad face.
- 4) Allow the pad to dry and reinstall the air filter.



SCAN OR CLICK TO WATCH INSTRUCTIONAL VIDEO

Inspection

Inspect the cup regularly for the following faults:

- cuts or damage to sealing edges of rubber pad.
- cracks or dents in handle or pump
- reappearance of red line soon after attaching cup
- sluggishness or dramatic changes in pump action
- slick surface or stiffness of rubber pad
- air filter missing from pad face

Correct any faults before using the cup (see Service).

Storage

Store the cup in clean, dry condition out of direct sunlight. Use the cover (29353) to protect the pad face from damage.

WARNINGS

Failure to observe WARNINGS could damage the vacuum cup or the load, or cause injury to the user.

- Do not use the cup to support loads that exceed the Maximum Load Capacity (see SPECIFICATIONS).
- Do not use the cup to support a person.
- Do not leave a cup unattended which could injure people if it disengages unexpectedly.
- Do not place the rubber pad against surfaces which could damage the sealing edges.
- Avoid conditions that could cause the cup to slip or to disengage prematurely, such as: contaminants, cuts or scratches in the pad face or contact surface; attaching the cup to porous materials; or applying pressure against the pad edge.
- Do not use the cup when the red line is visible. If the red line reappears frequently, discontinue use and see Service.
- Do not allow anything to interfere with free movement of the plunger while the cup is attached.
- Do not touch the release lever while using the cup.
- Do not use harsh chemicals (such as solvents or gasoline) or rubber cleaners and conditioners to clean the pad.

LIMITED WARRANTY

Wood's Powr-Grip products are guaranteed to be free of any defects in manufacturing or materials for **1 year from the date of purchase.**

Warranty does **NOT** cover:

- ✓ Cut or scratched rubber parts
- ✓ Parts damaged by customer
- ✓ Abnormal wear and tear
- ✓ Abuse, misuse or neglect
- ✓ Modified products

TROUBLESHOOTING

Scan or click the following codes for:



Troubleshooting Guide
Industrial Plastic Hand Cups



Ordering Replacement Parts
Industrial Plastic Hand Cups

KEEP FOR YOUR RECORDS

Record this information, in case you need to claim Warranty service.

Date of Purchase:

Purchased From:

Model Number:

Stock Number:

For additional warranty information, please scan or click this code or visit wpg.com/warranty.

